

DN25/1.00 TO DN65/2.50
MAINLINE ONLY

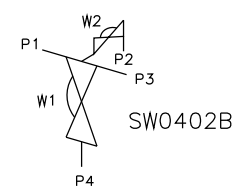

ORIENTATION AS
PER P&ID DIAGRAM
FOR OPTIMUM
DRAINABILITY.

The information on this sheet is Private and Confidential and is the property of Crane Process Flow Technologies Limited and must not be published directly or indirectly in any manner whatsoever without the written permission of the Company and must not be used in any way detrimental to their interests.
© Crane Process Flow Technologies

CRANE Process Flow Technologies
A Crane Co. Company

Saunders
The Science Inside

Title
SCHEDULE OF LEADING DIMENSIONS FOR DN25/1.00
WEIR 'T' BODY WITH DN8/0.25 BACK SAMPLE
ALL ENDS BUTT WELD OD TUBING

MAINLINE SIZE		A		B		C		D		øE		øF		G		H		I		øJ		K		L		M		BODY WEIGHTS	
mm	inch	mm	inch	mm	inch	mm	inch	mm	inch	mm	inch	mm	inch	mm	inch	mm	inch	mm	inch	mm	inch	mm	inch	mm	inch	mm	inch	mm	Kgs
DN25	1.00	50.8	2.00	50.8	2.00	15.1	0.59	35.0	1.38	25.4	1.00	22.1	0.87	14.7	0.58	70.0	2.76	18.0	0.71	13.6	0.54	8.4	0.33	70.0	2.76	51.5	2.03	2.1	
DN40	1.50	50.8	2.00	50.8	2.00	21.4	0.84	41.0	1.61	38.1	1.50	34.8	1.37	15.7	0.62	77.0	3.03	20.0	0.79	19.9	0.78	9.6	0.38	78.0	3.07	61.5	2.42	2.4	
DN50	2.00	50.8	2.00	50.8	2.00	27.8	1.09	41.0	1.61	50.8	2.00	47.5	1.87	15.7	0.62	77.0	3.03	20.0	0.79	26.3	1.04	9.6	0.38	91.0	3.58	74.5	2.93	2.6	
DN65	2.50	50.8	2.00	50.8	2.00	34.1	1.34	45.5	1.79	63.5	2.50	60.2	2.37	15.7	0.62	82.0	3.23	18.0	0.71	32.6	1.28	9.4	0.37	104.0	4.09	85.5	3.37	2.8	
DN80	3.00	50.8	2.00	50.8	2.00	40.5	1.59	48.0	1.89	76.2	3.00	72.9	2.87	15.7	0.62	89.0	3.50	20.0	0.79	35.5	1.40	9.6	0.38	117.0	4.61	97.0	3.82	2.6	
DN100	4.00	101.6	4.00	50.8	2.00	52.8	2.08	56.5	2.22	101.6	4.00	97.38	3.83	15.7	0.62	109.0	4.29	20.0	0.79	50.8	2.00	9.6	0.38	142.0	5.59	125.0	4.92	4.0	

Drawn RJ Date 11.10.11 UNCONTROLLED IN
Checked RND Date 29.07.13 HARD COPY FORMAT

First Angle Projection Method E DO NOT SCALE Drawing No. WEB-053 Issue. 3

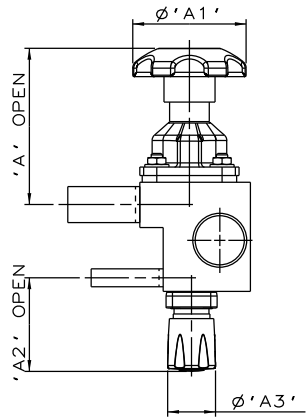

SS NON SEALED
& PURE PERFORMANCE
BONNET ASSEMBLY

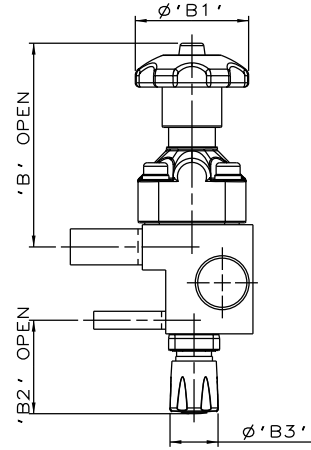

PES BONNET ASSEMBLY
& PURE PERFORMANCE
BONNET ASSEMBLY

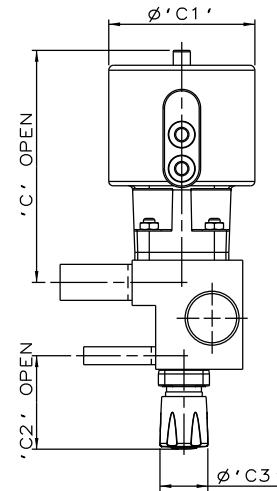

EC ACTUATOR (ALL MODES)
& PURE PERFORMANCE
BONNET ASSEMBLY

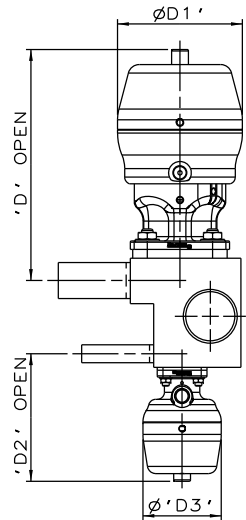

*S360 ACTUATORS

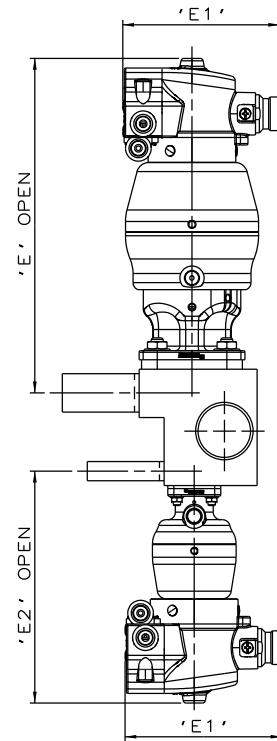

*S360 ACTUATOR
WITH M-VUE SENSOR

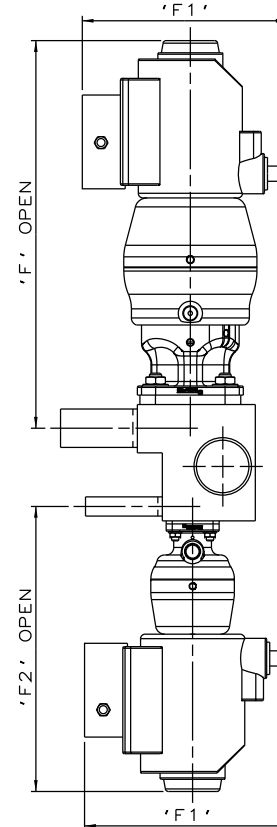

*S360 ACTUATOR
WITH I-VUE SENSOR

* DIMENSIONS SHOW MAXIMUM ENVELOPE FOR ALL MODES

BRANCH / SAMPLE SIZE	A	A1	A2	A3	B	B1	B2	B3	C	C1	C2	C3	D	D1	D2	D3	E	E1	E2	F	F1	F2
mm / inch	mm / inch	mm / inch	mm / inch	mm / inch	mm / inch	mm / inch	mm / inch	mm / inch	mm / inch	mm / inch	mm / inch	mm / inch	mm / inch	mm / inch	mm / inch	mm / inch	mm / inch	mm / inch	mm / inch	mm / inch	mm / inch	mm / inch
DN25xDN15 1.00x0.50	109.7 / 4.32	80.0 / 3.15	66.0 / 2.60	34.0 / 1.34	143.7 / 5.66	80.0 / 3.15	66.0 / 2.60	34.0 / 1.34	163.7 / 6.44	103.0 / 4.05	66.0 / 2.60	34.0 / 1.34	171.7 / 6.76	98.0 / 3.87	89.6 / 3.53	55.0 / 2.18	232.7 / 9.16	103.8 / 4.09	154.6 / 6.09	268.7 / 10.58	136 / 5.35	188.6 / 7.43

The information on this sheet is Private and Confidential and is the property of Crane Process Flow Technologies Limited and must not be published directly or indirectly in any manner whatsoever without the written permission of the Company and must not be used in any way detrimental to their interests.
© Crane Process Flow Technologies

CRANE	Process Flow Technologies A Crane Co. Company	Saunders The Science Inside
--------------	--	---------------------------------------

Title
SCHEDULE OF LEADING DIMENSIONS FOR DN25/1.00
WEIR 'T' BODY WITH DN8/0.25 BACK SAMPLE
ALL ENDS BUTT WELD OD TUBING
FITTED WITH TOPWORKS OPTIONS

Drawn R1	Date 30.06.16	UNCONTROLLED IN HARD COPY FORMAT
Checked RND	Date 30.06.16	

First Angle Projection	DO NOT SCALE	Drawing No. WEB-053-ASSY	Issue. 1
------------------------	--------------	-----------------------------	-------------