

DN8/0.25
WEIR SIZE ONLY

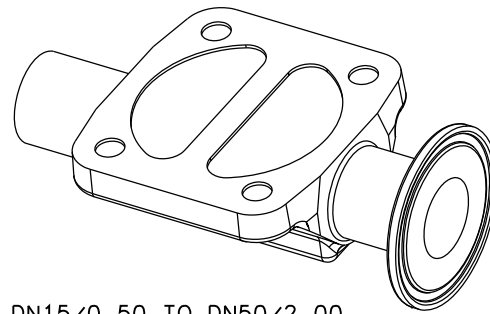

DN15/0.50 TO DN50/2.00
WEIR SIZE ONLY

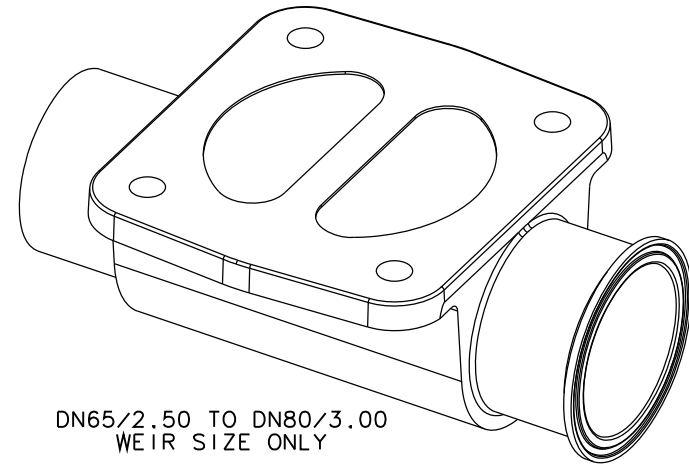

DN65/2.50 TO DN80/3.00
WEIR SIZE ONLY

VALVE SIZE	A		B		C		ØD		ØE		ØF		G	VALVE SIZE	
mm	inch	mm	inch	mm	inch	mm	inch	mm	inch	mm	inch	mm	inch	DEGREES	Kgs
DN8	0.25	78.0	3.07	21.5	0.85	8.6	0.34	6.35	0.25	3.05	0.12	25.0	0.98	35	0.13
DN8 (DN10 END)	0.25 (0.375 END)	78.0	3.07	21.5	0.85	8.6	0.34	9.53	0.38	6.23	0.25	25.0	0.98	27	0.14
DN8 (DN15 END)	0.25 (0.50 END)	78.0	3.07	21.5	0.85	8.6	0.34	12.7	0.50	9.4	0.37	25.0	0.98	19	0.14
DN15	0.50	108.0	4.25	30.0	1.18	9.4	0.37	12.7	0.50	9.4	0.37	25.0	0.98	41	0.22
DN20	0.75	117.0	4.61	28.5	1.12	13.0	0.51	19.05	0.75	15.75	0.62	25.0	0.98	32	0.37
DN25	1.00	127.0	5.00	28.5	1.12	15.7	0.62	25.4	1.00	22.1	0.87	50.4	1.98	30	0.66
DN40	1.50	159.0	6.26	32.0	1.26	22.0	0.87	38.1	1.50	34.8	1.37	50.4	1.98	25	1.15
DN50	2.00	190.0	7.48	41.0	1.61	28.4	1.12	50.8	2.00	47.5	1.87	63.9	2.52	24	1.90
DN65	2.50	217.0	8.54	41.5	1.63	40.5	1.59	63.5	2.50	60.2	2.37	77.4	3.05	19	4.48
DN80	3.00	254.0	10.00	48.0	1.89	48.0	1.89	76.2	3.00	72.9	2.87	90.9	3.58	24	7.12

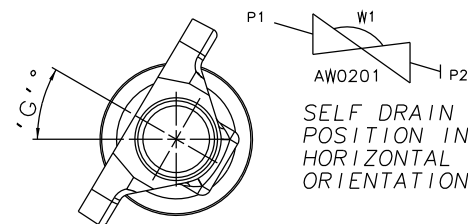

DRAIN ANGLE TOLERANCE = +/- 2°

The information on this sheet is Private and Confidential and is the property of Crane Process Flow Technologies Limited and must not be published directly or indirectly in any manner whatsoever without the written permission of the Company and must not be used in any way detrimental to their interests.
© Crane Process Flow Technologies

CRANE Process Flow Technologies
A Crane Co. Company

Saunders
The Science Inside

Title
SCHEDULE OF LEADING DIMENSIONS FOR 2-WAY
MKIII FORGED BODY COMPLETE WITH BUTT WELD
OD TUBE END AND HYGIENIC CLAMP END.
BS OVERALL LENGTH.

Drawn RI	Date 02.11.11	UNCONTROLLED IN HARD COPY FORMAT
Checked RND	Date 11.10.12	

First Angle Projection Method E		DO NOT SCALE	Drawing No. WEB-050	Issue. 2
---------------------------------------	--	--------------------	------------------------	-------------

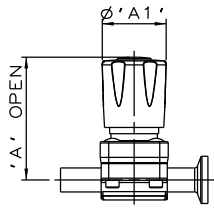

PURE PERFORMANCE BONNET ASSEMBLY

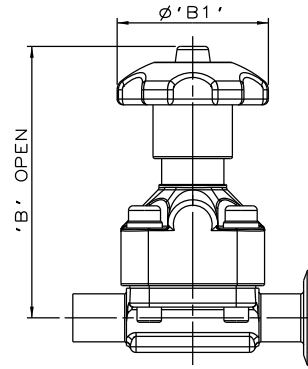

PES BONNET ASSEMBLY

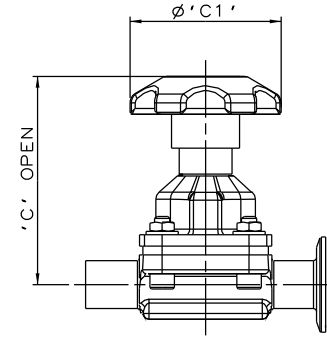

SS NON SEALED BONNET ASSEMBLY

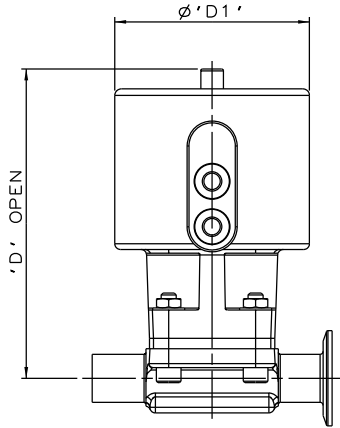

EC ACTUATOR (ALL MODES)

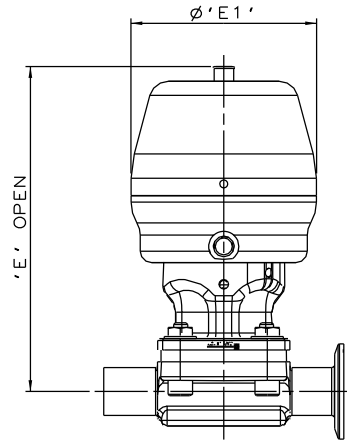

*S360 ACTUATOR

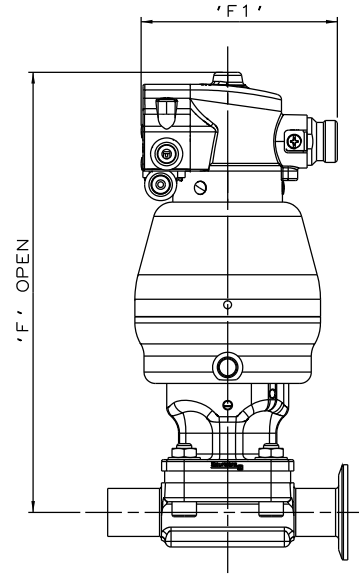

*S360 ACTUATOR WITH M-VUE SENSOR

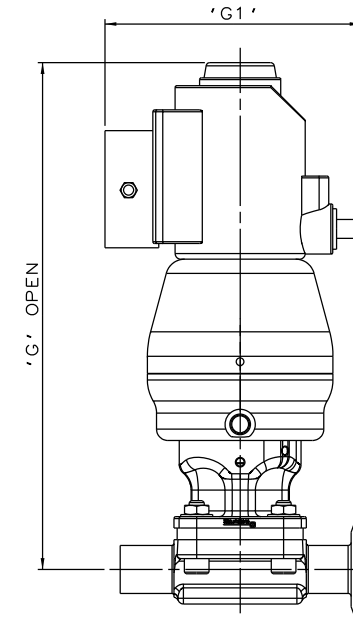

*S360 ACTUATOR WITH I-VUE SENSOR

*DIMENSIONS SHOW MAXIMUM ENVELOPE FOR ALL MODES

VALVE SIZE	A		A1		B		B1		C		C1		D		D1		E		E1		F		F1		G		G1	
mm inch	mm	inch	mm	inch	mm	inch	mm	inch	mm	inch	mm	inch	mm	inch	mm	inch	mm	inch	mm	inch	mm	inch	mm	inch	mm	inch	mm	inch
DN8 0.25	65.0	2.56	34.0	1.34	N/A	N/A	N/A	N/A	N/A	N/A	N/A	N/A	87.6	3.45	58.0	2.28	88.6	3.49	55.0	2.18	153.6	6.05	136.0	5.35	187.6	7.39	136.0	5.35
DN15 0.50	N/A	N/A	N/A	N/A	84.4	3.32	62.0	2.44	107.4	4.23	62.0	2.44	111.4	4.39	70.0	2.75	135.4	5.33	67.5	2.66	177.7	7.00	136.0	5.35	231.4	9.11	136.0	5.35
DN20 0.75	N/A	N/A	N/A	N/A	88.0	3.46	62.0	2.44	114.0	4.49	62.0	2.44	157.0	6.18	103.0	4.05	164.0	6.46	98.0	3.87	225.0	8.86	136.0	5.35	260.0	10.24	136.0	5.35
DN25 1.00	N/A	N/A	N/A	N/A	109.7	4.32	80.0	3.15	143.7	5.66	80.0	3.15	163.7	6.44	103.0	4.05	171.7	6.76	98.0	3.87	232.7	9.16	136.0	5.35	268.7	10.58	136.0	5.35
DN40 1.50	N/A	N/A	N/A	N/A	158.0	6.22	120.0	4.72	199.0	7.83	140.0	5.51	225.0	8.86	155.0	6.10	224.0	8.82	123.0	4.84	275.0	10.83	136.0	5.35	311.0	12.24	136.0	5.35
DN50 2.00	N/A	N/A	N/A	N/A	180.4	7.10	120.0	4.72	209.4	8.24	140.0	5.51	244.4	9.62	155.0	6.10	267.4	10.53	150.0	5.92	315.4	12.42	136.0	5.35	351.4	13.83	136.0	5.35
DN65 2.50	N/A	N/A	N/A	N/A	233.5	9.19	170.0	6.69	226.5	8.92	140.0	5.51	N/A	N/A	N/A	N/A	334.5	13.17	186.0	7.32	N/A	N/A	N/A	N/A	414.5	16.32	136.0	5.35
DN80 3.00	N/A	N/A	N/A	N/A	259.0	10.2	230.0	9.06	299.0	11.77	250.0	9.84	N/A	N/A	N/A	N/A	407.0	16.02	236.0	9.29	N/A	N/A	N/A	N/A	480.0	18.90	136.0	5.35

The information on this sheet is Private and Confidential and is the property of Crane Process Flow Technologies Limited and must not be published directly or indirectly in any manner whatsoever without the written permission of the Company and must not be used in any way detrimental to their interests.
 © Crane Process Flow Technologies

CRANE Process Flow Technologies
 A Crane Co. Company

Saunders
 The Science Inside

Title			
SCHEDULE OF LEADING DIMENSIONS FOR 2-WAY MKIII FORGED BODY WITH BUTT WELD/HYGIENIC CLAMP ENDS. BS OVERALL LENGTH FITTED WITH TOPWORKS OPTIONS.			
Drawn	JRD	Date	28.06.16
Checked	RND	Date	28.06.16
First Angle Projection Method E		DO NOT SCALE	
Drawing No.		Issue.	
WEB-050-ASSY		1	