

The information on this sheet is Private and Confidential and is the property of Crane Process Flow Technologies Limited and must not be published directly or indirectly in any manner whatsoever without the written permission of the Company and must not be used in any way detrimental to their interests.
 © Crane Process Flow Technologies

CRANE Process Flow Technologies
 A Crane Co. Company

Saunders
 The Science Inside

Title
 SCHEDULE OF LEADING DIMENSIONS FOR DN65/2.50
 WEIR 'T' BODY WITH BUTT WELD OD TUBE ENDS

Drawn R1	Date 29.09.11	UNCONTROLLED IN HARD COPY FORMAT
Checked RND	Date 21.03.12	
First Angle Projection Method E	DO NOT SCALE	Drawing No. WEB-011
		Issue. 2

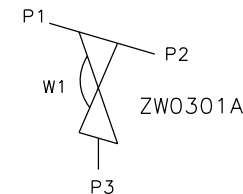

ORIENTATION AS
 PER P&ID DIAGRAM
 FOR OPTIMUM
 DRAINABILITY.

MAINLINE SIZE	A		B		C		D		ϕE		ϕF		G		H		BODY WEIGHT Kgs	
	mm	inch	mm	inch	mm	inch	mm	inch	mm	inch	mm	inch	mm	inch	mm	inch		
DN65	2.50	50.8	2.00	50.8	2.00	37.1	1.46	49.0	1.93	63.5	2.50	60.2	2.37	34.8	1.37	146.0	5.75	8.3
DN80	3.00	50.8	2.00	50.8	2.00	43.5	1.71	56.0	2.20	76.2	3.00	72.9	2.87	34.8	1.37	146.0	5.75	7.7
DN100	4.00	101.6	4.00	50.8	2.00	55.7	2.20	67.5	2.66	101.6	4.00	97.38	3.83	34.8	1.37	146.0	5.75	10.5

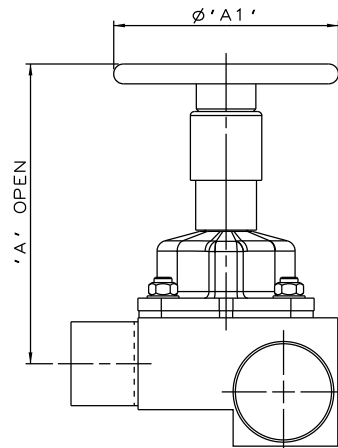

SS NON SEALED
BONNET ASSEMBLY

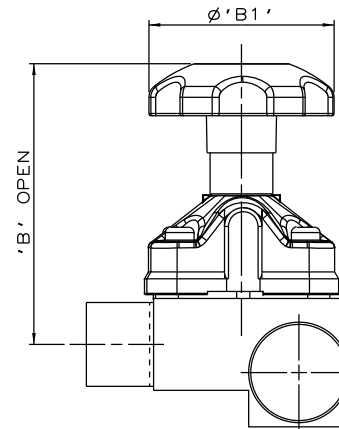

PES BONNET ASSEMBLY

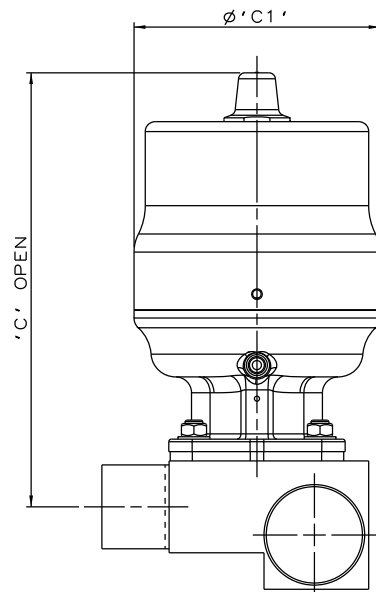

*S360 ACTUATOR

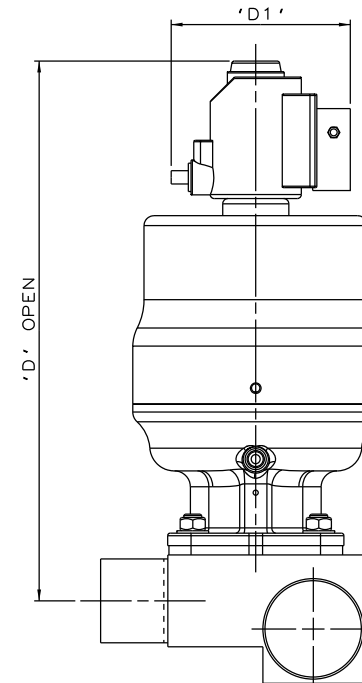

*S360 ACTUATOR
WITH I-VUE SENSOR

The information on this sheet is Private and Confidential and is the property of Crane Process Flow Technologies Limited and must not be published directly or indirectly in any manner whatsoever without the written permission of the Company and must not be used in any way detrimental to their interests.
© Crane Process Flow Technologies

CRANE Process Flow Technologies
A Crane Co. Company

Saunders
The Science Inside

Title
SCHEDULE OF LEADING DIMENSIONS FOR DN65/2.50
WEIR 'T' BODY WITH BUTT WELD OD TUBE ENDS
FITTED WITH TOPWORKS OPTIONS

Drawn JRD Date 28.09.16 UNCONTROLLED IN
Checked RND Date 28.09.16 HARD COPY FORMAT

First Angle Projection DO NOT SCALE Drawing No. Issue.
Method E WEB-011-ASSY 1

*DIMENSIONS SHOW MAXIMUM ENVELOPE FOR ALL MODES

MAINLINE SIZE		A		A1		B		B1		C		C1		D		D1	
mm	inch	mm	inch	mm	inch	mm	inch	mm	inch	mm	inch	mm	inch	mm	inch	mm	inch
DN65	2.50	227	8.94	170	6.7	213	8.39	140	5.51	328	12.91	186	7.32	408	16.06	135.5	5.33