

www.cranecpe.com

Stainless Steel Sealed Bonnet Assembly

For applications requiring all stainless steel construction

Key features include:

- 1 Stainless steel, hand wheel, compressor and spindle
- 2 Fully sealed, with a primary seal that provides absolute containment for critical applications.
- 3 Electropolished finish
- 4 Operational at temperatures up to 160°C - Suitable for Steam-In-Place (SIP) 0.5" - 0.75"
- 5 Fully autoclavable up to 140°C
- 6 Available in size range DN15-DN80 (0.50"-3.00")



Please visit our web-based drawing library at:
www.saundersdrawings.com

Stainless Steel Sealed Manual Bonnet

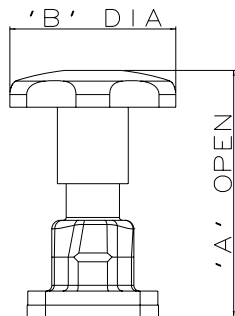

DN15 to DN20 only
0.5" - 0.75"

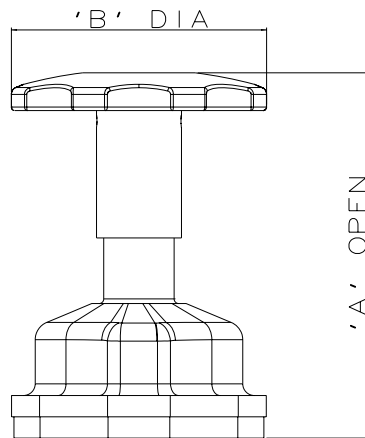

DN25 to DN50 only
1.0" - 2.0"

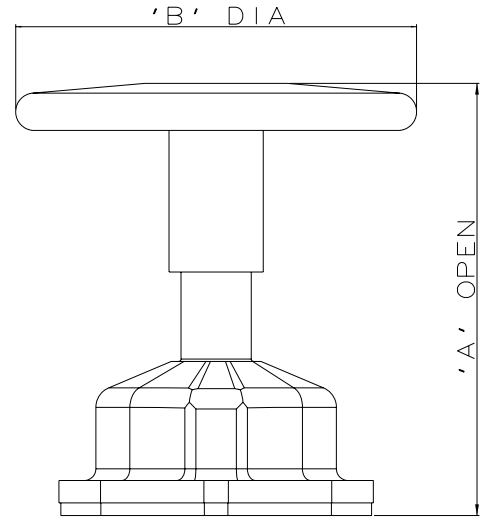

DN65 to DN80 only
2.5" - 3.0"

Valve Size

Valve Size		A		B	
mm	inch	mm	inch	mm	inch
DN15	0.50	88	3.46	62	2.44
DN20	0.75	89	3.50	62	2.44
DN25	1.00	102.5	4.04	80	3.15
DN40	1.50	133	5.24	100	3.94
DN50	2.00	154.5	6.08	112	4.41
DN65	2.50	185.5	7.30	170	6.69
DN80	3.00	203	7.99	220	8.66

Weights

Size	Weight (kg)	Weight (lbs)
DN15 (0.5")	0.9	2.0
DN20 (0.75")	1.1	2.4
DN25 (1.0")	1.3	2.9
DN40 (1.5")	1.9	4.2
DN50 (2.0")	3.5	7.7
DN65 (2.5")	6.2	13.6
DN80(3.0")	8.4	18.5



www.cranecpe.com

CRANE ChemPharma & Energy, Saunders® · 9860 Johnson Road · Montgomery, Texas USA 77316 · Tel: +1 936 588 8360 · Fax: +1 936 588 8302
CRANE Process Flow Technologies Ltd. · Grange Rd, · Cwmbran, Gwent NP44 3XX · +44 1633 486666 · Fax: +44 1633 486777

IMPORTANT: Crane Co., and its subsidiaries cannot accept responsibility for possible errors in catalogues, brochures, other printed materials, and website information. Crane Co. reserves the right to alter its products without notice, including products already on order provided that such alteration can be made without changes being necessary in specifications already agreed.